

SPECIFICATIONS:

Door Thickness: 1 1/4" to 1 3/4"

Finish Options: Brushed Stainless, Matte Black, Bronze

Material: Stainless Steel

Fabrication: Some site fabrication may be required.

JRE Hardware barn door hardware has the following weight allowances:

- Weight 80Kgs: max distance between the clamps = 1/2 the width of the door
- Weight 80-120Kgs: max distance between the clamps = 1/3 the width of the door
- Weight 120-150Kgs: max distance between the clams = 1/3 the width of the door

The maximum working load of the CY902 should not exceed 200Kgs

Installation

CY- 902 FACE MOUNTED HANGING SLIDING DOOR KIT -- Instruction Sheet

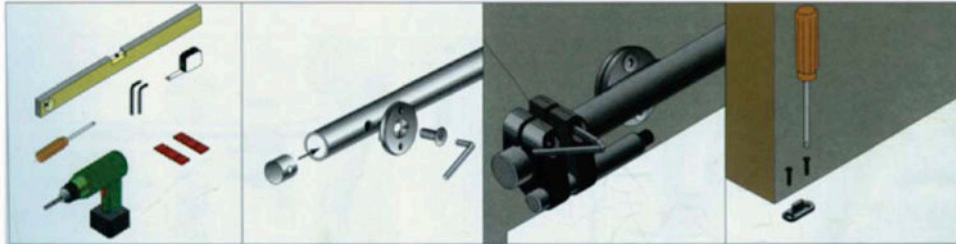

- 1: Tools for installation
- 2: In a straight line on the guide rail measure and even spacing or according to solid backing for the mounting supports to be affixed to. With a 1/8th drill bit drill a pilot hole at the measured intervals. Be careful to ensure that they are perfectly straight. Next follow through with a 3/8ths bit suited for stainless steel. (Wall mount spacing must be increased with excessive weight. See Below.) When drilling is complete slide the mounting anchor to the desired position in the guide rail. This is easily done with a dowel or a stop from the opposite end in the required position. Thread mounting studs on tight ensuring they are all in a straight line.
- 3: Slide on door stops to either end of the guide rail at the desired intervals. Final adjustments may be made after the door is hung. Place the end caps in both ends of the rail and lightly tap until they are in the required position. Last mount the door rail at the desired position with competent backing in the wall. (Scribing supports ensures an accurate installation.)
- 4: Secure the floor guide to the floor ensuring that the door is standing in the desired position.
- 5: Mount the face mount door rollers to the desire height on the door (please check chart below for spacing.) This will require 1" countersink holes on the rear side of the door and a 5/8ths countersink on the front with a 3/8ths hole through. Depending on the size of the door and desired look the recommended placement of the holes is 3" to 5" in from either side.
- 6: Hang the door on the rail and ensure proper placement of the floor guide.
- 7: Make any final adjustments necessary.

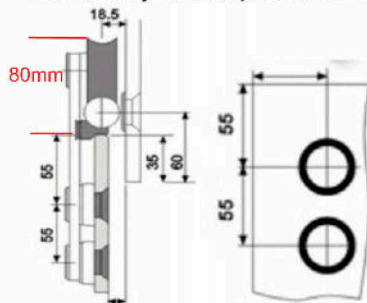

*The distance for clamp fixing for track to wall

- 1) Weight 80kg: max-distance between the clamps=1/2 the width of the door
- 2) Weight 80kg~120kg: max-distance between the clamps=1/3 the width of the door
- 3) Weight 120kg~150kg: max-distance between the clamps=1/4 the width of the door

The maximum working load limits should not exceed 200kgs